

## MF1608T SERIES – Thin Film Ceramic Chip Inductors

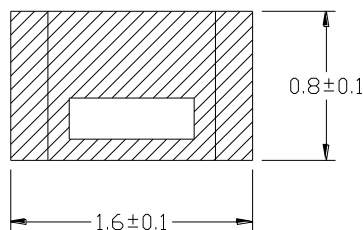

TOP VIEW



FRONT VIEW

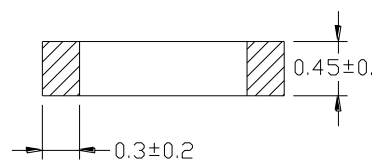

| PART NUMBER     | INDUCTANCE (nH) | Tolerance (% or nH) | Q Min.    | SRF (GHz) Min. | DCR (Ω) (Max.) | IDC (mA) (Max.) |
|-----------------|-----------------|---------------------|-----------|----------------|----------------|-----------------|
| MF1608T-1N0□-LF | 1.0             | 0.1/0.2/0.3nH       | 15@300MHz | 13             | 0.35           | 800             |
| MF1608T-1N2□-LF | 1.2             | 0.1/0.2/0.3nH       | 15@300MHz | 13             | 0.35           | 800             |
| MF1608T-1N5□-LF | 1.5             | 0.1/0.2/0.3nH       | 15@300MHz | 10             | 0.35           | 800             |
| MF1608T-1N8□-LF | 1.8             | 0.1/0.2/0.3nH       | 15@300MHz | 10             | 0.35           | 300             |
| MF1608T-2N2□-LF | 2.2             | 0.1/0.2/0.3nH       | 15@300MHz | 8              | 0.35           | 300             |
| MF1608T-2N7□-LF | 2.7             | 0.1/0.2/0.3nH       | 15@300MHz | 6              | 0.45           | 300             |
| MF1608T-3N3□-LF | 3.3             | 0.1/0.2/0.3nH       | 15@300MHz | 6              | 0.45           | 300             |
| MF1608T-3N9□-LF | 3.9             | 0.1/0.2/0.3nH       | 15@300MHz | 6              | 0.45           | 300             |
| MF1608T-4N7□-LF | 4.7             | 0.1/0.2/0.3nH       | 15@300MHz | 5              | 0.55           | 300             |
| MF1608T-5N6□-LF | 5.6             | 0.1/0.2/0.3nH       | 15@300MHz | 5              | 0.65           | 300             |
| MF1608T-6N8□-LF | 6.8             | 0.1/0.2/0.3nH       | 15@300MHz | 5              | 0.75           | 300             |
| MF1608T-8N2□-LF | 8.2             | 0.1/0.2/0.3nH       | 15@300MHz | 4              | 0.95           | 300             |
| MF1608T-10N□-LF | 10              | 1/2/3/5%            | 15@300MHz | 4              | 0.95           | 300             |
| MF1608T-12N□-LF | 12              | 1/2/3/5%            | 15@300MHz | 3              | 1.05           | 300             |
| MF1608T-15N□-LF | 15              | 1/2/3/5%            | 15@300MHz | 3              | 1.35           | 300             |
| MF1608T-18N□-LF | 18              | 1/2/3/5%            | 15@300MHz | 2              | 1.65           | 300             |
| MF1608T-22N□-LF | 22              | 1/2/3/5%            | 15@300MHz | 2              | 1.95           | 250             |
| MF1608T-27N□-LF | 27              | 1/2/3/5%            | 15@300MHz | 2              | 2.35           | 250             |
| MF1608T-33N□-LF | 33              | 1/2/3/5%            | 15@300MHz | 1.5            | 2.75           | 250             |
| MF1608T-39N□-LF | 39              | 1/2/3/5%            | 15@300MHz | 1.5            | 3.00           | 200             |

## MF1608T SERIES – Thin Film Ceramic Chip Inductors



| PART NUMBER     | INDUCTANCE (nH) | Tolerance (% or nH) | Q Min.    | SRF (GHz) Min. | DCR ( $\Omega$ ) (Max.) | IDC (mA) (Max.) |
|-----------------|-----------------|---------------------|-----------|----------------|-------------------------|-----------------|
| MF1608T-47N□-LF | 47              | 1/2/3/5%            | 15@300MHz | 1.5            | 3.00                    | 200             |
| MF1608T-56N□-LF | 56              | 1/2/3/5%            | 15@300MHz | 1              | 5.00                    | 150             |
| MF1608T-68N□-LF | 68              | 1/2/3/5%            | 15@300MHz | 1              | 5.00                    | 150             |
| MF1608T-R10□-LF | 100             | 1/2/3/5%            | 15@300MHz | 1              | 7.50                    | 100             |

- Inductors tolerance range : 0.1nH ; 0.2nH ; 0.3nH ;  $\pm 1\%$  ;  $\pm 2\%$  ;  $\pm 3\%$  ;  $\pm 5\%$ .
- Test equipment : Agilent/HP-4287A LCR meter or equivalent .
- Operating temperature range -40°C to +85°C , Electrical specifications at 25°C .
- Packing : 7" reel, machine-ready ,embossed plastic tape ( 4,000 parts per full reel).

### SOLDERING PROFILE

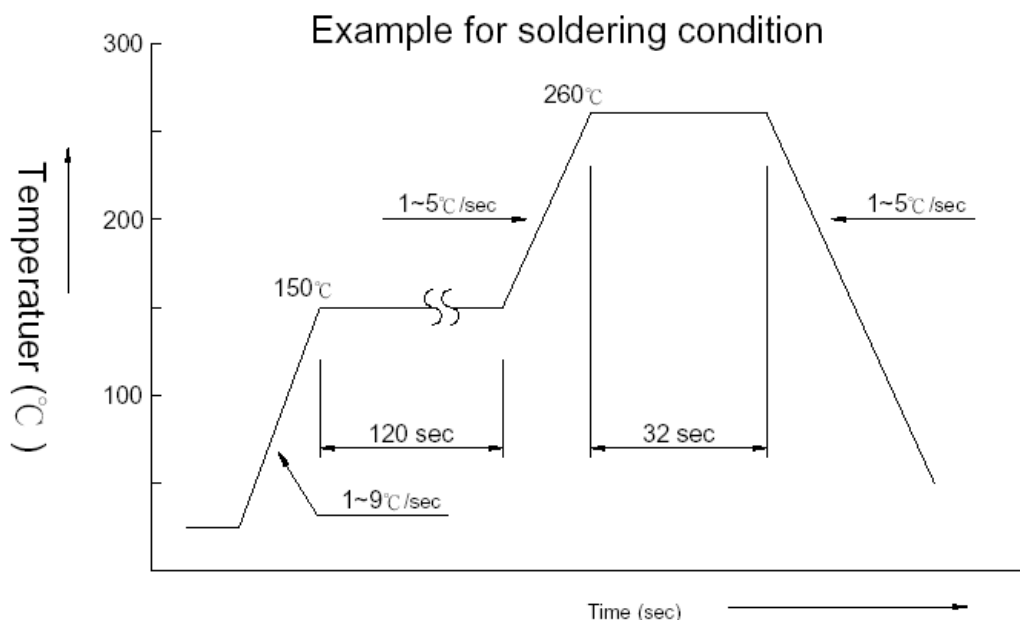

Solder : Sn96.5/Ag3/Cu0.5